

K2 POWER E 25 KX 10" Subwoofer

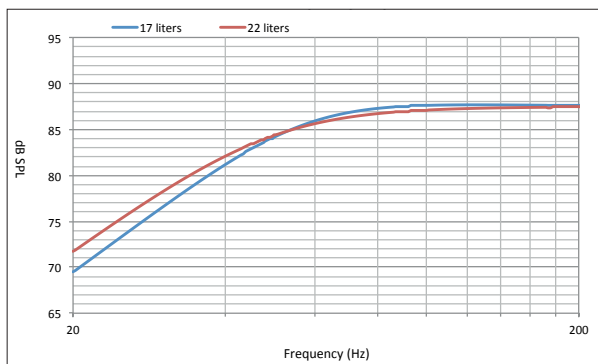

- K2 Power sandwich cone
- Aluminum basket
- Dual voice coil (2x40hms)

FREQUENCY RESPONSE



MECHANICAL DRAWING

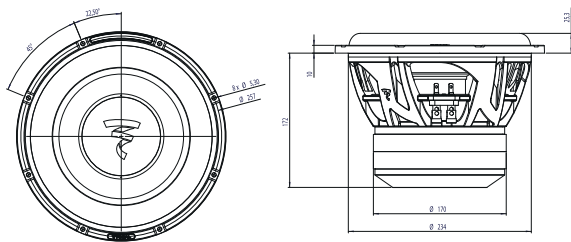

SPECIFICATIONS

| | | |
|------------------------|-----------------|--------------------|
| Nominal power | 600W RMS | |
| Maximum power | 1200W | |
| Sensitivity (2.83V/1m) | 87.5dB | |
| Cone | Kevlar sandwich | |
| Surround | Butyl | |
| Nom. impedance | 4+4 Ω | |
| DC resistance | 3.2+3.2 Ω | |
| VC diameter | 65mm | 2 ^{9/16"} |
| Former | Glass fiber | |
| Layers | 4 | |
| Wire | CCAW | |
| Net weight | 10.6kg | 23.4lbs |

PARAMETERS

| | |
|------|--------------------|
| Rdc | 3.2+3.2 Ω |
| Fs | 38Hz |
| Mms | 163g |
| Cms | 0.12mm/N |
| Vas | 20l |
| Qts | 0.52 |
| Qes | 0.58 |
| Qms | 5 |
| Bxl | 21.5 N/A |
| Sd | 327cm ² |
| SPL | 84.5dB |
| Xmax | 22.5mm |

SUGGESTED APPLICATION

Sealed enclosure

| Volume | F-3 (Hz) |
|--------------------|----------|
| 17L 0.35 cu.ft. | 51Hz |
| 22L 0.52 cu.ft. | 48Hz |

Ported enclosure

| Volume | F-3 (Hz) | Ø event Ø port | LG event Port length |
|--------------------|----------|---------------------------|------------------------------|
| 22L 0.88 cu.ft. | 33Hz | 8cm 3 ^{5/32"} | 35cm 13 ^{25/32"} |
| 30L 1.05 cu.ft. | 27Hz | 8cm 3 ^{5/32"} | 43cm 16 ^{15/16"} |



Elite
"HAUTE COUTURE" SOUND



FOCAL[®]
THE SPIRIT OF SOUND